

Installation

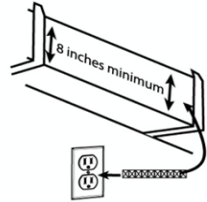

1 Localice el área apropiada para la instalación

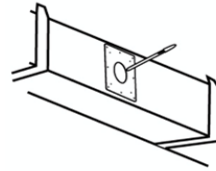

2 Usando la placa de montaje marque la apertura de 9 cm

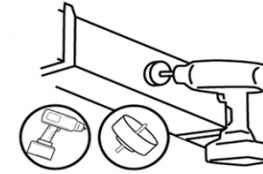

3 Realice un agujero de 9 cm con una sierra de corona.

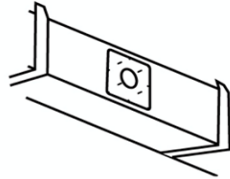

4 Instale la base

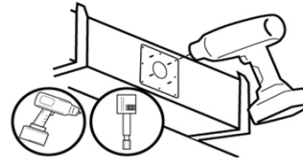

5 Fije la base al ducto.

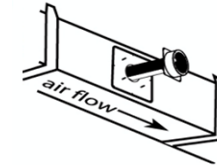

6 Inserta la unidad en el hueco. Asegurando que su posición es perpendicular la flujo del aire

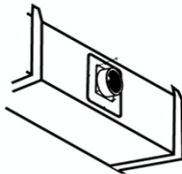

7 Asegurar la unidad atornillandola a la base.

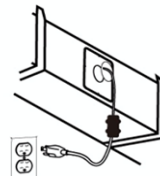

8 Alimentar la undiad.

